

# SATAKE

Optical sorting solutions.

## RGBR Full Color, Shape and NIR Sorter

MODEL  
**3401** (3 chutes ~ 15 tons/hr)

MODEL  
**5401** (5 chutes ~ 25 tons/hr)



RGBR5401DMS





# The Satake RGBR is a full color, shape and NIR sorter engineered to meet the most challenging requirements.



The **Satake RGBR** optical sorter features advanced full color sorting technology with RGB camera image analysis, and is ideally suited to sort dry beans, tree nuts, grains and other agricultural products. It features shape sorting to remove non-uniform reject product of different size. The **RGBR** can also be equipped with the latest near infrared (NIR) cameras to provide additional capability with the detection of FM impurities such as glass, plastic, stones and other inorganic material that may be similar in color to the good product.

- 1 Full Color RGB Cameras
- 2 Size and Shape Sorting
- 3 Advanced Touch Screen User Interface
- 4 Near Infrared (NIR) Camera Function
- 5 Automatic Profile Creation and Calibration
- 6 LED Lighting and Illumination
- 7 4mm Air Ejector Spacing Density
- 8 Real-Time Accept/Reject Product Sampling
- 9 Primary-Secondary-Tertiary Sorting System

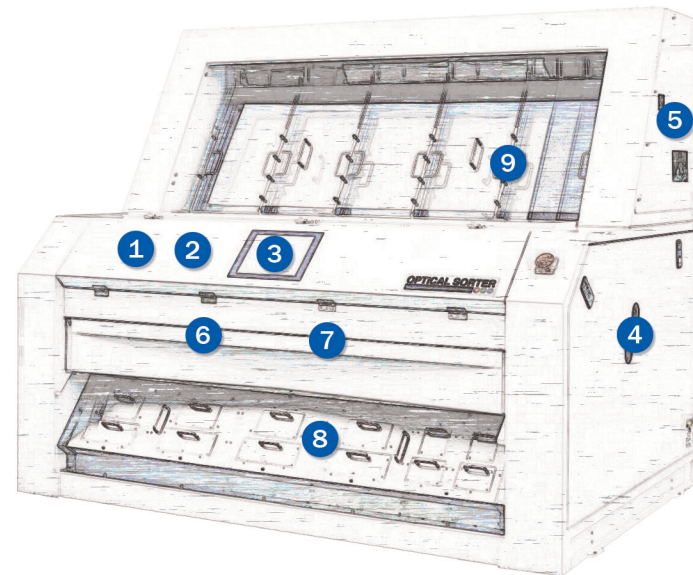

## Typical Product Applications



Dry Beans



Tree Nuts



Soybeans



Peanuts



Coffee



Corn Seed

### NIR Camera FM Detection

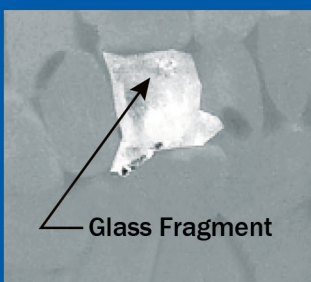

Glass Fragment

Impurities such as glass, plastic, sticks and rocks which have the exact color as the accept product can easily be detected in the near infrared (NIR)

spectrum. The **RGBR** series can detect and remove inorganic and foreign materials utilizing the latest InGaAs NIR camera technology as an added assurance.

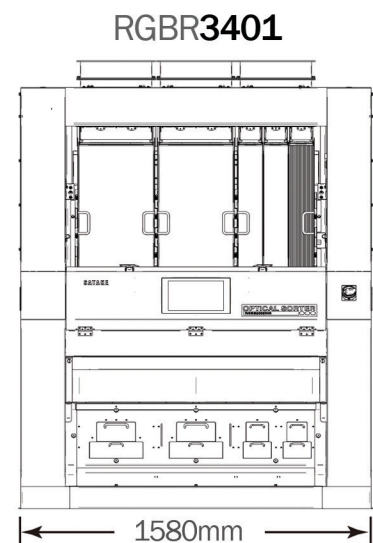

RGBR3401

1580mm

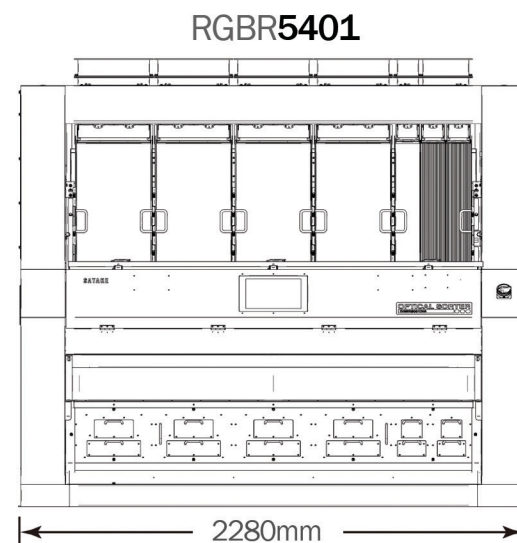

RGBR5401

2280mm

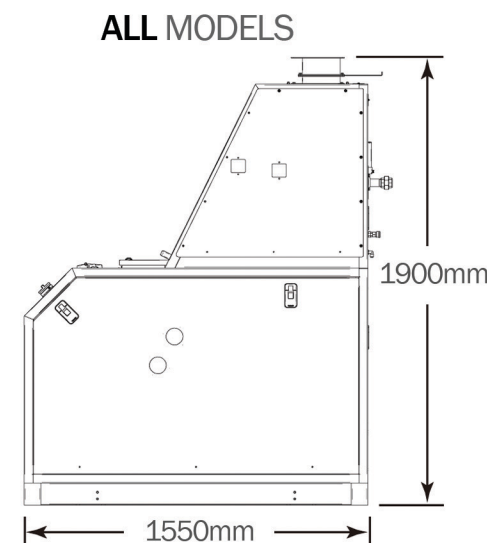

ALL MODELS

1900mm

## MACHINE SPECIFICATIONS

MODEL		3401(BM)	3401(AMS)	3401(DMS)	5401(BM)	5401(AMS)	5401(DMS)
Number of Chutes	Primary	Flat 336 x 3	Flat 336 x 2	Flat 336 x 2	Flat 336 x 5	Flat 336 x 3	Flat 336 x 3
	Secondary	--	Flat 336 x 1	Flat 112 x 2	--	Flat 336 x 2	Flat 336 x 1 Flat 112 x 1
	Tertiary	--	--	Groove 112 x 1	--	--	Groove 112 x 2
* Typical Capacity (t/h)		~15	~9	~9	~25	~19	~19
RGB Cameras / Resolution		6 x RGB / 2048 pixels			10 x RGB / 2048 pixels		
** NIR Cameras		3 x Near Infrared			5 x Near Infrared		
Lighting (RGB / NIR)		RGB-LED / IR-LED			RGB-LED / IR-LED		
Ejectors / Density		252 / 4mm			420 / 4mm		
Air Consumption		600 - 1500 NL/min			1000 - 2000 NL/min		
Compressor (kW)		5.5 - 11.0			7.5 - 15.0		
Power Supply (V)		Single Phase 200 - 240			Single Phase 200 - 240		
Power Consumption (kW)		1.1			2.0		
Net Weight (kg)		920			1615		
Operation		12-inch Full Color Touch Panel			12-inch Full Color Touch Panel		

\* Sorting performance and capacity depends on product type and contamination percentage. \*\* NIR Camera Function is optional.





# SATAKE

[www.satake-usa.com/rgrb](http://www.satake-usa.com/rgrb)

If you are interested in a free RGRB demonstration using your own product, or if you need more information, contact one of our local test facilities.

**NORTH, CENTRAL, SOUTH AMERICA**  
Satake USA Inc. (Corporate Office)  
Houston, Texas USA  
Tel: 281.276.3600

**WEST COAST USA**  
Satake USA Inc.  
Modesto, California USA  
Tel: 209.551.3203

**EUROPE, MIDDLE EAST, AFRICA**  
Satake Europe Limited  
Stockport, Cheshire England  
Tel: 44.161.406.3800

